

FOR CONTINUATION.  
SEE DRAWING NO. 0011

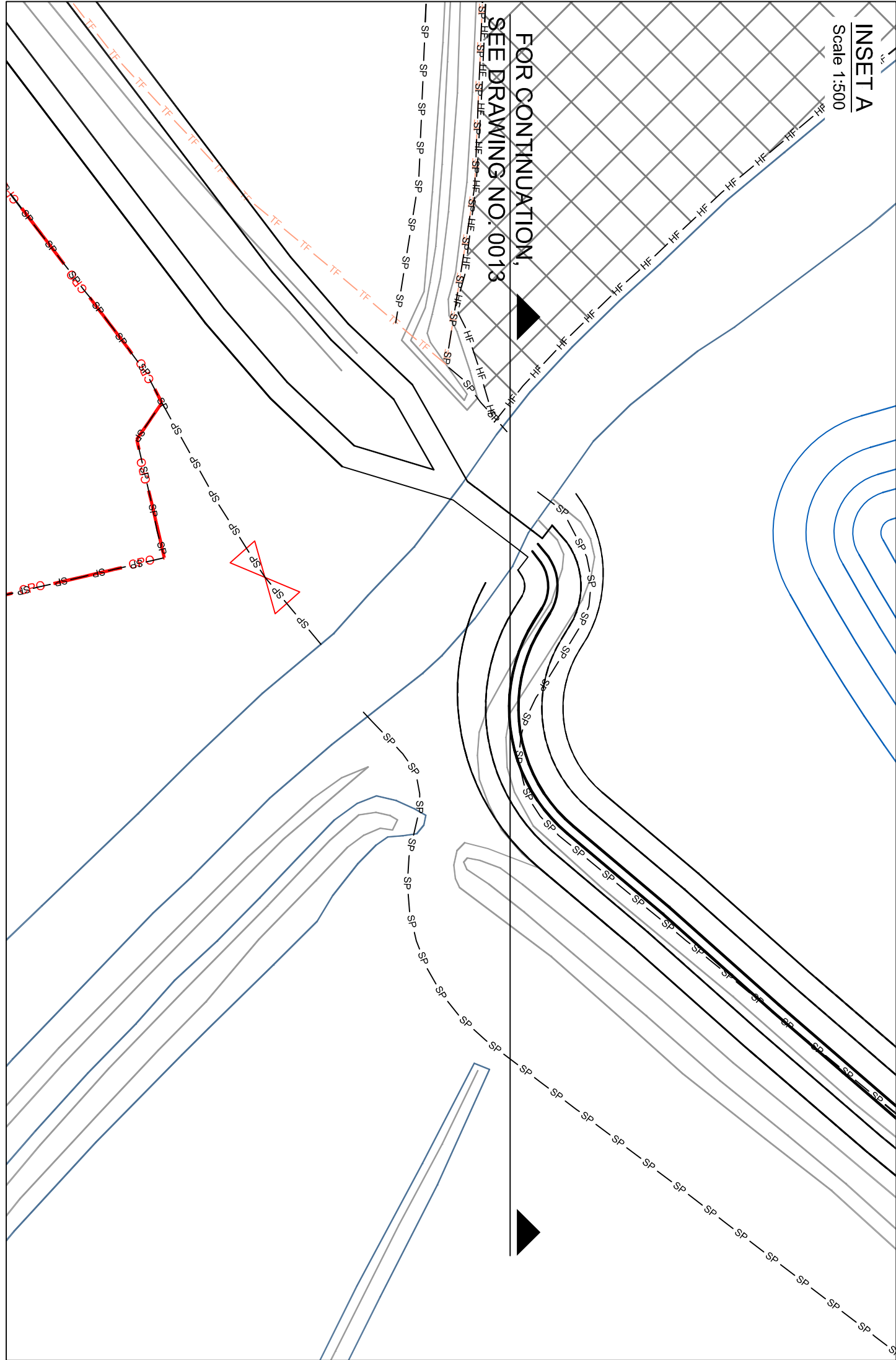
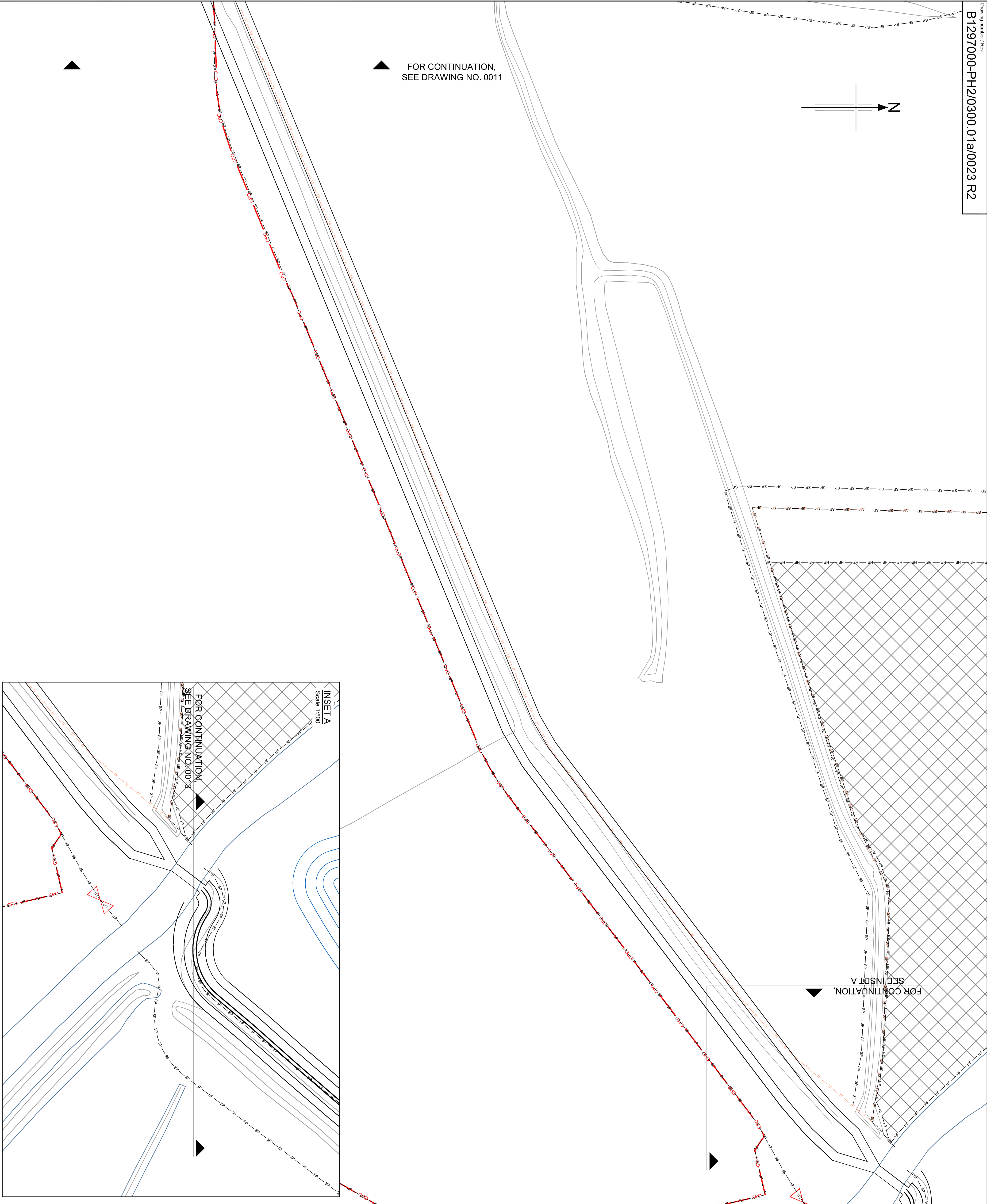

NOTES

1. Refer to drawing number B1297000/0300.01a/0000 for Key plan.
2. All drawings are to be read in conjunction with Appendix 3/1 Fencing, Gates and Sills.
3. Stock Proof Fencing- It has been assumed that all Agricultural fencing requires stock proof fencing; this is to be reviewed following confirmation of land use/maintenance.
4. Gates- The location and provision of gates and sills are to be reviewed in conjunction with the landowner.
5. Noise Barrier- To be placed on highway boundary or offset up to 1m inside highway boundary subject to agreement with adjacent landowners.
6. Noise Barrier- Close boarded timber noise attenuation barrier.
7. Badger gates- One way badger gates to be provided along the route of the link road at a minimum of 500m spacing on both side of the link road.
8. Badger proof fencing to taper towards mammal tunnel entrances.
9. Where stock proof / noise proof fencing and badger fencing are required in close proximity a design solution to combine fence types will be considered.

KEY

- CPD Boundary
- Standard timber post and Rail
- Stock Proof
- Badger Proof
- Stock/Badger Proof
- Bat Fence
- Temporary Fence
- Timber Post and Wire
- Absorptive Noise Barrier
- Reflective Noise Barrier (Height - 1.8m)
- Reflective Noise Barrier (Height - 1.5)
- Hempile Fence
- Gate
- Badger Gate (2 way)
- Noise Bund
- Temporary Fencing SSSI

SAFETY, HEALTH AND ENVIRONMENTAL INFORMATION

In addition to the hazards/risks normally associated with the type of work detailed on this drawing, note the following:

CONSTRUCTION

MAINTENANCE / CLEANING

DECOMMISSIONING / DEMOLITION

It is assumed that all works will be carried out by a competent contractor working, where appropriate, to an appropriate national standard.

Reproduction from the Ordnance Survey Map with the permission of the controller of Her Majesty's stationery office Crown copyright reserved Licence No. AL 100017326

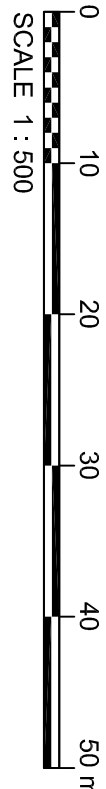

Rev	Rev Date	Purpose of revision	Drawn	Checked	Rev'd	Appr'd
R2	14/12/2012	ISSUE FOR INFORMATION	DM	RS	SG	RD
R1	12/11/2012	ISSUE FOR INFORMATION	DM	RS	SG	RD
RO	02/11/2012	INITIAL ISSUE	DM	DM	PGF	RD

Client

Simpson House, 8 Cherry Orchard Road, Clonsilla, Dublin 15, Ireland  
Tel: +353(0)1 288 8272 Fax: +353(0) 288 81 2469  
www.jacobs.com

Employer

Project: BEXHILL TO HASTINGS LINK ROAD

Drawing title: FENCING

SHEET 23 OF 32

Drawing status: ISSUE FOR REVIEW

Scale	1:500 @ A1	DO NOT SCALE
Jacobs No.	B1297000-PH2	
Client No.		

Drawing number: B1297000-PH2/0300.01a/0023

Rev: R2

This drawing is not to be used in whole or part other than for the intended purpose and project as defined on this drawing. Refer to the contract for full terms and conditions.